

APPROVED

PLAN CHECK # 1	8/27/07
REVISIONS	DATE

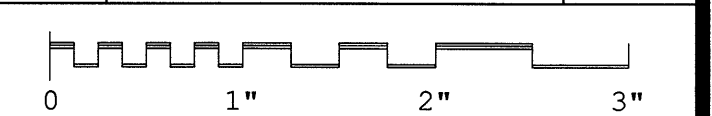

THE ORIGINAL
Lincoln Logs[®]
LTD.
5 RIVERSIDE DRIVE, P.O. BOX 135
CHESTERTOWN, NEW YORK 12817
PHONE: (518) 494-5500 FAX: (518) 494-7495
COPYRIGHT © 2007 LINCOLN LOGS LTD.

Status	Final Drawing
Drafter	M. Rice
Checked	
Scale	1/4" = 1'-0"
Date	3-20-07
Order No.	0728004-630
Cad File	Pfeifer.pln

CUSTOMER
Pfeifer Residence
3317 Green Mountain Road
Kalama, WA
Cowlitz County

SHEET TITLE
Foundation ELEC.

Drawing No.
14
SHEET

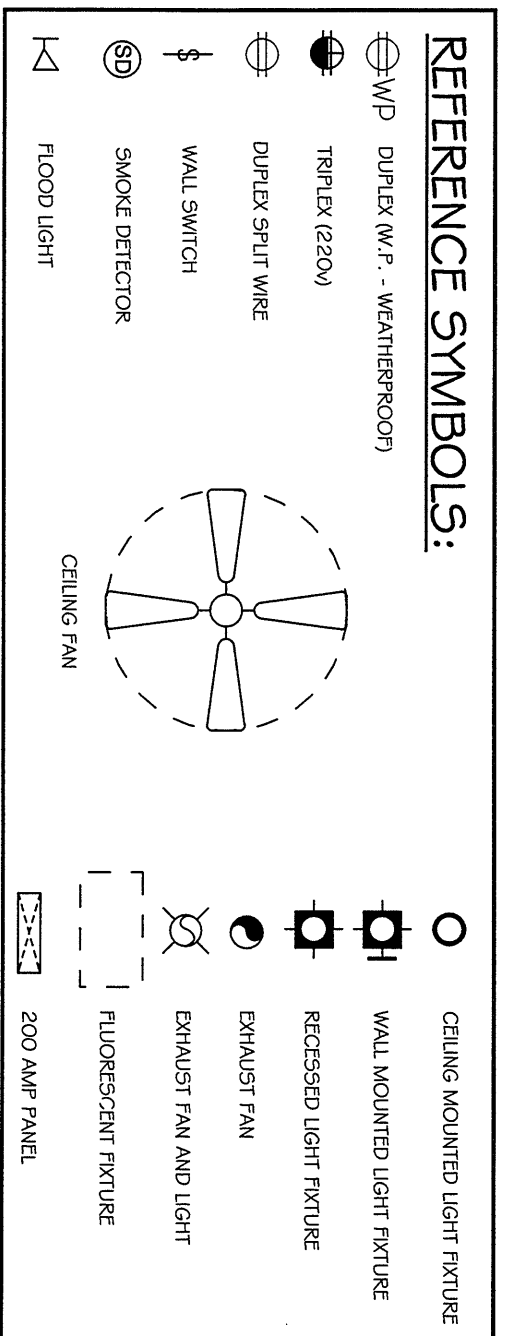

1. ALL WORK SHALL BE IN ACCORDANCE WITH ALL CODES, RULES AND REGULATIONS AND SHALL COMPLY WITH THE REQUIREMENTS OF THE SERVING POWER AND TELEPHONE COMPANIES.
2. RECEPTACLES AT THE EXTERIOR OF THE HOME MUST BE LOCATED WITHIN 6'-6" OF GRADE, OR PROTECTED AND WATERPROOF PER 316.2.
3. APPLIANCE INSTALLED IN A GARAGE GENERATING A GLOW SPARK, OR FLAME TO BE LOCATED 18" ABOVE FLOOR AND SEISMICALLY BRACED. UMC 508
4. WATER HEATERS SHALL BE ANCHORED OR STRAPPED TO RIGID HORIZONTAL STRUCTURE DUE TO EARTHQUAKE MOTION. ONE THIRD OF ITS VERTICAL DIMENSIONS. AT THE LOWER PORT A MINIMUM DISTANCE OF 4" SHALL BE MAINTAINED ABOVE THE CONTROLS WITH THE STRAPPING. UNITS SHALL BE SECURED BY 1-1/2" x 1/8" GALV. STRIPS AND 5/16" x 3" LAG SCREWS ANCHORED INTO WALL FRAMING MEMBERS. CIRC 310
5. ALL WALL HEATING DEVICES, RADIATORS, AND OR FINRAYS SHALL HAVE COMBUSTION AIR OPENINGS WITHIN 12" OF THE FLOOR AND THE HIGHEST POINT IN THE GARAGE.
6. 7/8" RELIEF VALVES TO TERMINATE OUTSIDE OF BLDG. WITHIN 6" TO 24" OF THE GRADE. UMC 508
7. ALL ELECTRICAL OUTLETS LOCATED ON THE OPPOSITE SIDE OF RATED FIRE WALLS SHALL HAVE A MIN. 24" HORIZONTAL, 10" VERTICAL CLEARANCE AND CLEARANCE AT WATER HEATER UMC 1311
8. PROVIDE GFI PROTECTION FOR RECEPTACLES IN THE BATHROOM, KITCHEN & GARAGE. GFI PROTECTION IS REQUIRED FOR ALL RECEPTACLES IN THE GARAGE. NEC 210.8(A) (2)(4)
9. ALL ELECTRICAL WORK SHALL BE PERFORMED IN ACCORDANCE WITH THE NATIONAL ELECTRICAL CODE (NEC) AND ALL APPLICABLE LOCAL ORDINANCES. A NON-REMOVABLE BACKFLOW PREVENTION DEVICE IS TO BE PROVIDED AT ALL EXT. ON HOSE BIBS. UMC 503
10. UMC 504, 309.
11. PROVIDE SWITCHED OUTLETS 18" ABOVE FLOOR FOR 22. COBET LIGHTING SHALL BE 18" MIN. FROM COMBUSTIBLES MEASURED BOTH VERTICALLY AND HORIZONTALLY.
12. INSTALL SMOKE DETECTORS ON PERMANENTLY WIRED CIRCUIT (NOT GFI) AT LOCATION INDICATED ON THE ELECTRICAL PLAN. ALL SMOKE DETECTORS SHALL BE HARDCWIRED AND ALL HARDCWIRED DETECTORS SHALL BE INTERCONNECTED TO ACTIVATE ALL ALARMS IN DWELLING.
13. USE ONLY CCC CERTIFIED APPLIANCES, SHOWER HEAD, AND FAUCETS.
14. ALL INSTALLATION INSTRUCTIONS FOR ALL LISTED EQUIPMENT TO BE INSTALLED TO BE FIELD INSPECTOR AT THE TIME OF INSPECTION. UMC 303.1
15. DRYER VENT FITTINGS SHALL BE INSTALLED ON ALL TRUCKS AND HOSE BIB OUTLETS AND SECURELY FASTENED TO ADJACULATE BRACKING WITH SCREWS. ALL TRUCKS WITH A MINIMUM R/C OF 15" HEAD ABOVE FLOOR LEVEL. SECOND FLOOR TRUCKS SHALL BE TESTED TO A LEVEL ABOVE TUB OVERFLOW.
16. 4" TRAPS INSTALLED BETWEEN FLOORS AND CONCEALED INSIDE WALLS SHALL HAVE A SOLID CONNECTION IN THE TRAP SEAL SUPPLY PIPING FOR A BUILDING SUPPLY FOR RESIDENTIAL STRUCTURES SHALL BE A MINIMUM OF 1" HEALTH AND SAFETY CODE.
17. SHOWER AND TUB-SHOWER COMBINATIONS SHALL BE PROVIDED WITH AN EXHAUST FAN OR THE PRESSURE BALANCE TO THE DRYER EXHAUST TO BE SMOOTH METAL DUCT EXTENDING TO THE OUTSIDE AND EQUIPPED WITH A BACK DRAFT DAMPER. UMC 504, 309.
18. PROVIDE SWITCHED OUTLETS 18" ABOVE FLOOR FOR 22. COBET LIGHTING SHALL BE 18" MIN. FROM COMBUSTIBLES MEASURED BOTH VERTICALLY AND HORIZONTALLY.
19. PROVIDE TWO SMALL APPLIANCE BRANCH CIRCUITS FOR THE KITCHEN THAT ARE LIMITED TO SUPPLYING WALL THE DRYER EXHAUST TO BE SMOOTH METAL DUCT EXTENDING TO THE OUTSIDE AND EQUIPPED WITH A BACK DRAFT DAMPER. UMC 504, 309.
20. PROVIDE A DEDICATED 20 AMP CIRCUIT TO SERVE THE DRYER EXHAUST TO BE SMOOTH METAL DUCT EXTENDING TO THE OUTSIDE AND EQUIPPED WITH A BACK DRAFT DAMPER. UMC 504, 309.
21. PROVIDE TWO SMALL APPLIANCE BRANCH CIRCUITS FOR THE KITCHEN THAT ARE LIMITED TO SUPPLYING WALL THE DRYER EXHAUST TO BE SMOOTH METAL DUCT EXTENDING TO THE OUTSIDE AND EQUIPPED WITH A BACK DRAFT DAMPER. UMC 504, 309.
22. PROVIDE TWO SMALL APPLIANCE BRANCH CIRCUITS FOR THE KITCHEN THAT ARE LIMITED TO SUPPLYING WALL THE DRYER EXHAUST TO BE SMOOTH METAL DUCT EXTENDING TO THE OUTSIDE AND EQUIPPED WITH A BACK DRAFT DAMPER. UMC 504, 309.
23. PROVIDE TWO SMALL APPLIANCE BRANCH CIRCUITS FOR THE KITCHEN THAT ARE LIMITED TO SUPPLYING WALL THE DRYER EXHAUST TO BE SMOOTH METAL DUCT EXTENDING TO THE OUTSIDE AND EQUIPPED WITH A BACK DRAFT DAMPER. UMC 504, 309.
24. PROVIDE TWO SMALL APPLIANCE BRANCH CIRCUITS FOR THE KITCHEN THAT ARE LIMITED TO SUPPLYING WALL THE DRYER EXHAUST TO BE SMOOTH METAL DUCT EXTENDING TO THE OUTSIDE AND EQUIPPED WITH A BACK DRAFT DAMPER. UMC 504, 309.
25. PROVIDE TWO SMALL APPLIANCE BRANCH CIRCUITS FOR THE KITCHEN THAT ARE LIMITED TO SUPPLYING WALL THE DRYER EXHAUST TO BE SMOOTH METAL DUCT EXTENDING TO THE OUTSIDE AND EQUIPPED WITH A BACK DRAFT DAMPER. UMC 504, 309.
26. TERMINATION OF ALL ENVIRONMENTAL AIR DUCTS SHALL BE MINIMUM OF 3'-0" FROM PROPERTY LINES OR ANY OPENINGS IN THE BUILDING (i.e. DECKS, PATIOS AND UTILITY OPENING SINGLES OR ATTIC VENTS). UMC 504, 309.
27. FACTORY-MADE FLEXIBLE AIR DUCTS ARE TO BE INSTALLED ACCORDING TO THEIR INSTALLATION INSTRUCTIONS AND STANDARDS SET BY THE CODE AND ARE TO USE UL 1810 FLEX. UMC 504, 309.
28. PROVIDE TWO SMALL APPLIANCE BRANCH CIRCUITS FOR THE KITCHEN THAT ARE LIMITED TO SUPPLYING WALL THE DRYER EXHAUST TO BE SMOOTH METAL DUCT EXTENDING TO THE OUTSIDE AND EQUIPPED WITH A BACK DRAFT DAMPER. UMC 504, 309.
29. PROVIDE TWO SMALL APPLIANCE BRANCH CIRCUITS FOR THE KITCHEN THAT ARE LIMITED TO SUPPLYING WALL THE DRYER EXHAUST TO BE SMOOTH METAL DUCT EXTENDING TO THE OUTSIDE AND EQUIPPED WITH A BACK DRAFT DAMPER. UMC 504, 309.
30. PROVIDE TWO SMALL APPLIANCE BRANCH CIRCUITS FOR THE KITCHEN THAT ARE LIMITED TO SUPPLYING WALL THE DRYER EXHAUST TO BE SMOOTH METAL DUCT EXTENDING TO THE OUTSIDE AND EQUIPPED WITH A BACK DRAFT DAMPER. UMC 504, 309.
31. PROVIDE TWO SMALL APPLIANCE BRANCH CIRCUITS FOR THE KITCHEN THAT ARE LIMITED TO SUPPLYING WALL THE DRYER EXHAUST TO BE SMOOTH METAL DUCT EXTENDING TO THE OUTSIDE AND EQUIPPED WITH A BACK DRAFT DAMPER. UMC 504, 309.
32. PROVIDE TWO SMALL APPLIANCE BRANCH CIRCUITS FOR THE KITCHEN THAT ARE LIMITED TO SUPPLYING WALL THE DRYER EXHAUST TO BE SMOOTH METAL DUCT EXTENDING TO THE OUTSIDE AND EQUIPPED WITH A BACK DRAFT DAMPER. UMC 504, 309.
33. PROVIDE TWO SMALL APPLIANCE BRANCH CIRCUITS FOR THE KITCHEN THAT ARE LIMITED TO SUPPLYING WALL THE DRYER EXHAUST TO BE SMOOTH METAL DUCT EXTENDING TO THE OUTSIDE AND EQUIPPED WITH A BACK DRAFT DAMPER. UMC 504, 309.
34. PROVIDE TWO SMALL APPLIANCE BRANCH CIRCUITS FOR THE KITCHEN THAT ARE LIMITED TO SUPPLYING WALL THE DRYER EXHAUST TO BE SMOOTH METAL DUCT EXTENDING TO THE OUTSIDE AND EQUIPPED WITH A BACK DRAFT DAMPER. UMC 504, 309.

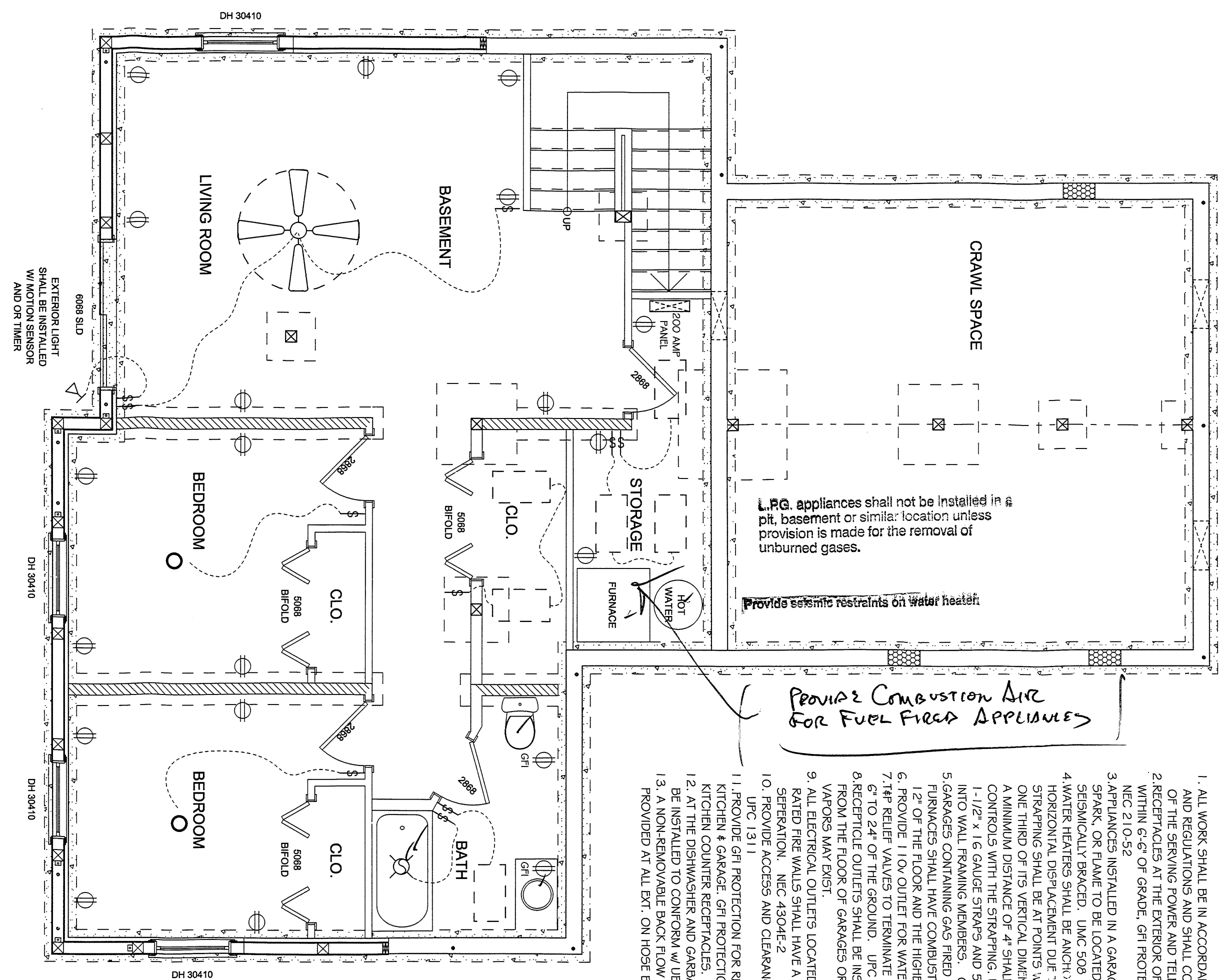

LOWER LEVEL ELECTRICAL

NOTE:
1. MA, STATE VENTILATION & INDOOR AIR QUALITY CODE 2003 CONSTRUCTION MUST COMPLY WITH THE PREScriptive VENTILATION REQUIREMENTS VMAQC 303 OR SUBMIT ENGINEERING CALCULATIONS TO SHOW COMPLIANCE WITH VMAQC 302.

INCOMING AIR:

1. OUTDOOR AIR IS REQUIRED TO BE SUPPLIED TO ALL HABITABLE ROOMS FOR ALL WHOLE HOUSE VENTILATION SYSTEMS.
2. IF INTEGRATED FORCED-AIR VENTILATION SYSTEM IS USED IT SHALL HAVE AN OUTDOOR AIR INLET. PROVIDE OUTDOOR AIR INLET DUCT CONNECTING TO THE RETURN AIR PLenum OF THE FORCED AIR SYSTEM INCLUDING DAMPER. VMAQC 303.4.2.1
3. IF INDIVIDUAL ROOM OUTDOOR AIR INLETS ARE USED PROVIDE WINDOW FORTS OR OUTDOOR AIR INLETS WITH SCREENS AND SECURE OPENINGS NOT LESS THAN FOUR SQUARE INCHES. VMAQC 303.4.1.5-4

OUT GOING AIR:

4. PROVIDE WHOLE HOUSE VENTILATION SYSTEM PER VMAQC 303.41.
5. PROVIDE WHOLE HOUSE EXHAUST FAN ON TIMER.
6. COMBINED SOURCE SPECIFIC FANS FOR WHOLE HOUSE EXHAUST INTEGRATED W/ FORCED-AIR SYSTEM.
7. PROVIDE SOURCE SPECIFIC FANS USING VMAQC TABLE 9.11.
8. OUTDOOR AIR INLETS SHALL NOT BE PLACED IN THE FOLLOWING LOCATIONS. (VMAQC 303.4.2.4)
 - a. CLOSER THAN 10' FROM AN APPLIANCE VENT UNLESS SUCH VENT OUTLET IS 3' ABOVE INLET.
 - b. WHERE IT WILL PICK UP ODORABLE ODORS, FLAMES OR FLAMMABLE VAPORS.
 - c. A HAZARDOUS OR UNSAFE LOCATION.
 - d. A ROOM OR SPACE HAVING AIR FUEL-BURNING APPLIANCES.